

GARDENS



FLOOR PLANS

This plan is included as a service to our customers and is intended as a guide to layout only. 'Dimensions are approximate do not scale.'

Please type or click this weblink to see interactive floor plans

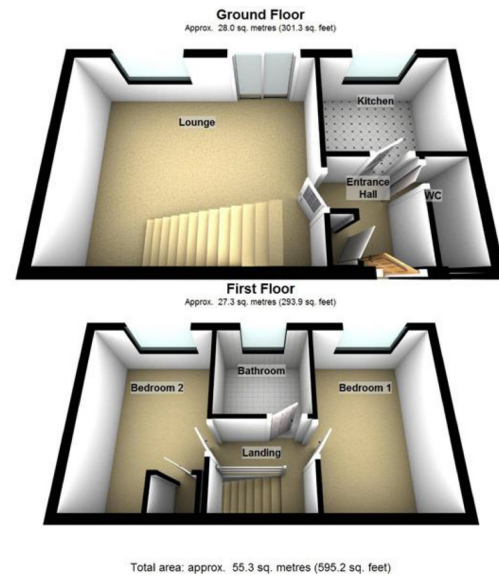

LOCATION

ENERGY PERFORMANCE CERTIFICATE



£134,950

28 Lawndale Drive, Ellenbrook, Worsley, Manchester, M28 1EN

- 2 Bedroom Mews Property
- Lounge, Guest W.C.
- Modern Fitted Kitchen
- Double Glazing, Gch
- Modern Bathroom, Garden
- Off Road Parking
- No Chain
- Ellenbrook Location

We are pleased to offer for sale this two double bedroom mid mews property situated on a cul de sac in a sought after location. Situated within easy access of; Local amenities, the A580 and motorway network. No chain. Viewing essential.

NOTE TO PROSPECTIVE PURCHASERS

Should you wish to make an offer on one of our properties we would advise you to contact our office in the first instance, prior to contacting your lender or solicitor, to avoid incurring any unnecessary costs.

Russell James offer a free valuation service to any prospective purchaser looking to sell their property. This service is provided without obligation.

Russell James also offers a free independent mortgage advice service. This service is provided without obligation.

GROUND FLOOR

ENTRANCE HALL

LOUNGE/ DINING ROOM

4.67m x 3.96m (15'4" x 13'0")

Fire set in wooden feature fire surround. Window to front patio door to rear.

MODERN FITTED KITCHEN

2.49m x 1.96m (8'2" x 6'5")

Fitted with a range of wall and base units with co-ordinating worktops, electric oven, gas hob with extractor over, spaces for washing machine and fridge/freezer. Partially tiled walls and window to rear.

GUEST W C

Fitted with a pedestal wash hand basin and low level w.c. Window to front.

FIRST FLOOR



GUEST W C



LOUNGE/ DINING ROOM



MODERN FITTED KITCHEN